



一閃即逝的靈感，綻著微弱的光芒，她的身影溫柔沉靜，是繆思女神的微笑，總出現在你不經意的平凡，會議中神遊的筆尖、停滯阻塞的號誌燈前，又或者夜幕低垂益發活躍的天馬行空。柔和的光芒，蘊藏著遠大的夢想，繆思在無窮的夜裡為你點亮夢想的火花。

CASTLE MUSE 系列推出全新吊燈款式，以更輕盈的姿態現身，凝鍊靈感的光芒。融合乳白玻璃與混凝土材質，構築出極簡而獨特的美感。

By Chen, Chao Cheng 陳昭成

Derived from Greek mythology, the Muses were nine goddesses who symbolized the highest achievements in art and science. Today, a muse is known as a person or object that inspires creativity. At SEED Design, we've captured that spark of ingenuity in our own creation—the CASTLE MUSE Pendant.

Crafted from a unique fusion of opal glass and concrete, this pendant is stunning in its simplicity. Available in both classic grey concrete and a deep, dramatic "Noir," each version brings its own distinct personality and presence to any space.



concrete gray + matt opal

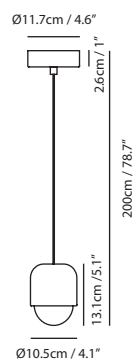

concrete dark grey + matt opal

**Canopy A117-1**
chrome

Ø11.7cm / 4.6" 2.6cm / 1"

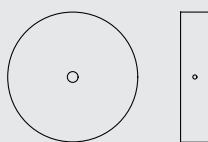
**Bracket A8**

11.4cm / 4.5"

7.4cm / 2.9"



2.4cm / 0.95"

Castle Muse Pendant**Model**
SG-1012P**Material**
concrete, glass**Light Source**
G9 LED 1 x 4W 2700K CRI90**Weight**
1.1kg / 2.43lb**Color**

- concrete gray + matt opal
- concrete dark grey